

Point loads on the platform to be placed or transferred using transversal supports to the longitudinal beams

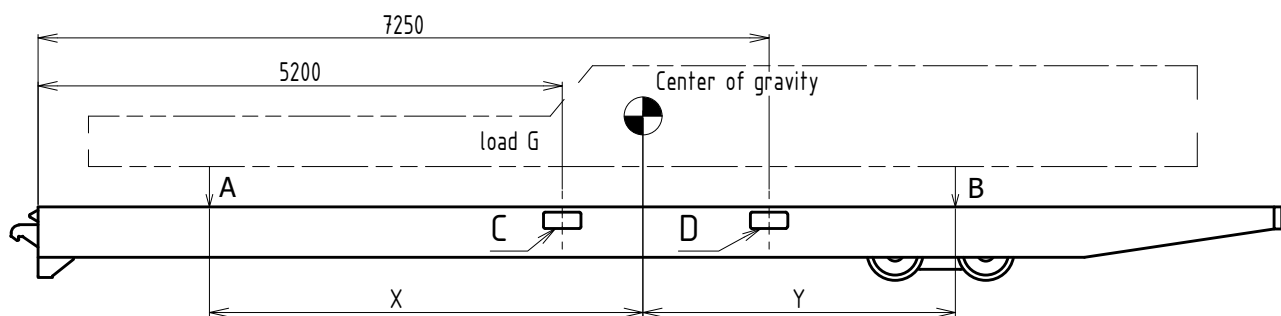
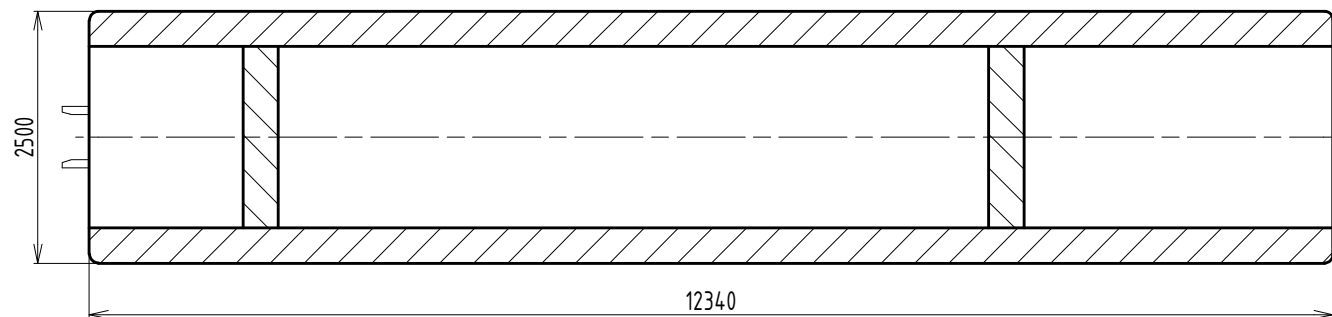

Loading instruction

$$B = \frac{G \cdot X}{X + Y} \quad A = G - B$$

- 1) Identify loads center of gravity
- 2) Calculate the loads, coming to the Rolltrailer platform acc to above scheme
- 3) Make sure, load center of gravity is in the determined area
- 4) Loads A and B shall not exceed the limit line in above diagram
- 5) Loads A and B must not reach places C and D (holes in the beam)

Distributed load

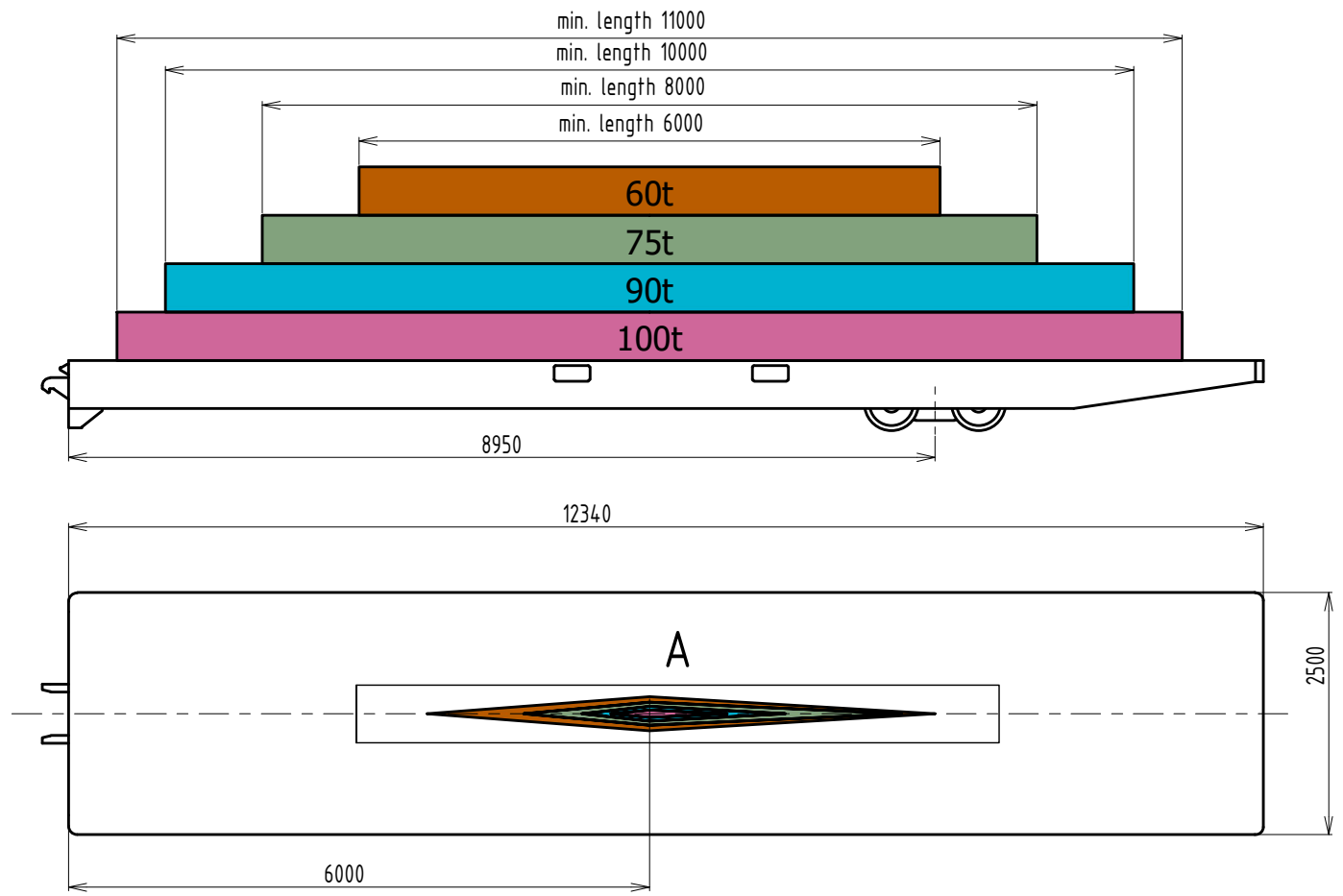

Load center of gravity must be within the areas, corresponding to the load

